

CALPROSMART™

Instruction for use for:
CalproSmart™ RUO Self-Test
For measurement of fecal Calprotectin



LIST OF CONTENT

1	INTENDED USE.....	3
2	BACKGROUND.....	3
3	PRINCIPLE OF THE TEST.....	3
4	MATERIALS.....	3
4.1	Reagents and components supplied with the kit.....	3
4.2	Materials and equipment required but not supplied.....	4
5	STABILITY AND STORAGE.....	4
6	Registration and download of the application.....	4
6.1	CalproSmart standalone application.....	4
7	PREPARATION.....	5
7.1	EasySampler.....	5
7.2	Test cassette.....	5
8	Performing the CalproSmart self-test.....	5
8.1	Collection of faecal sample.....	5
8.2	Extraction using the extraction device.....	6
8.3	Applying the sample on the test cassette.....	6
8.4	Performing the measurements.....	7
8.5	Disposal.....	7
9	QUALITY CONTROL.....	7
10	LIMITATIONS OF THE PROCEDURE.....	8
11	PRECAUTIONS AND WARNINGS.....	8
12	DISPOSAL CONSIDERATIONS.....	8
13	REFERENCES.....	9
14	ORDER INFORMATION.....	10

CalproSmart™ RUO Kit for measurement of fecal calprotectin

1 INTENDED USE

The CalproSmart™ RUO test is a method for the determination of Calprotectin levels in human stool samples in combination with the dedicated CalproSmart™ RUO smartphone applications.

For Research Use Only.

2 BACKGROUND

Calprotectin is a 24 kDa dimer¹ formed by the monomers S100A8 (10,835 Da) and S100A9 (13,242 Da)^{2,3}. Calprotectin has a high affinity for calcium, zinc⁴, produced by PMNs, monocytes and squamous epithelial cells (except those in normal skin)[Click or tap here to enter text.](#)⁶. After binding of calcium, it can resist degradation by leukocytic and microbial enzymes^{5,7}. By competing with different enzymes⁸ for limited, local amounts of zinc, Calprotectin can inhibit many zinc-dependent enzymes and thereby kill microorganisms or animal and human cells in culture^{9,10}.

Many studies have shown elevation of Calprotectin in various bodily fluids, including serum/plasma, CSF, saliva, urine, synovial fluid and feces⁴, and have been shown to be elevated in various acute and chronic conditions, such as various rheumatic conditions and diseases, inflammatory bowel disease (IBD), SLE, various cancers, sepsis, and other bacterial infections and acute and chronic inflammations.

3 PRINCIPLE OF THE TEST

The **CalproSmart™ RUO** is based upon preparation of an extract of faeces using our patented Faecal Extraction Buffer. The level of Calprotectin is determined by testing the extract in a lateral flow immunoassay specific for Calprotectin.

The sample is added to the sample well of the test cassette and is allowed to react with gold-conjugated antibodies which bind the Calprotectin. Calprotectin and conjugated antibody complexes travel together along the membrane and bind to Calprotectin-specific antibodies immobilised on the Test line. This immobilisation causes the Test line to form. Gold-conjugated antibody without any bound antigen is immobilised on the Control line. After ended incubation time the concentration of calprotectin in the sample is calculated by means of the CalproSmart™ RUO smartphone application. The colour intensity is proportional with the concentration of Calprotectin in the sample. The test is calibrated using faecal extracts with known concentrations, determined in the CalproLab™ ALP Calprotectin ELISA (Calpro AS, prod. No. CALP0170). The reportable range of the test is 77-1500 mg of calprotectin/kg of faeces, with the linear range up to 1100 mg/kg. Between 1100 and 1500 mg/kg the results can be inaccurate.

4 MATERIALS

4.1 Reagents and components supplied with the kit

- A) **EasySampler:** Disposable paper samplers for collection of stool samples and nitrile gloves.
- B) **Extraction device:** Faecal extraction device, prefilled with 5 ml Calpro faecal extraction buffer. The device is designed to collect 10 mg of faecal sample and give a 1:500 extract.
- C) **Rapid test cassettes:** Tests individually sealed in aluminium foil with desiccant bag. The cassettes are disposable

- D) **Support frame:** Rectangular plastic frame with an opening for placement of the rapid test cassette, labelled with a design that allows the smartphone app to identify the position of the control and test line and read the test result.

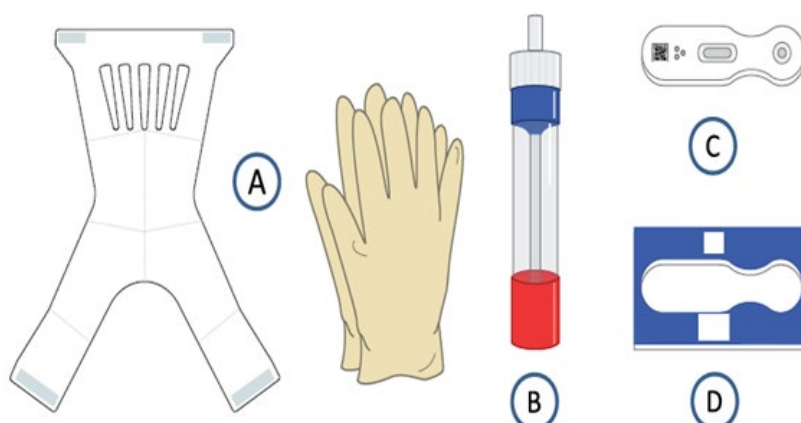

4.2 Materials and equipment required but not supplied

1. Paper tissue - sheet or towel

5 STABILITY AND STORAGE

When stored unopened at 2 – 8°C, kit reagents are stable up to the expiry date stated on the label.

Avoid exposure to high temperature and direct sunlight.

6 REGISTRATION AND DOWNLOAD OF THE APPLICATION

6.1 CalproSmart standalone application

Upon registration of the lay user connected to the clinic, research laboratory or study organizer, the clinic/researcher/study organizer (defined as clinic user in the system) enters the user's name, date of birth and e-mail address into the system. Once completed, the lay user will receive following e-mail:

Hi (user's name),

A new account has been created for you at calprosmart.com.

You now need to set your password by visiting the following webpage:

http://calprosmart.com/password_reset/.../

This page will expire after 24 hours, you can however request another password reset at any time.

Thanks,

The Calpro team.

Once completed setting the password, the lay-user can download the CalproSmart app. Download the app from App Store or Google Play by searching for “CalproSmart” or by scanning the QR code to the right and selecting the appropriate operating system. Ensure that the logo is identical to the one shown to download correct version of the app.



When the user logs on using their credentials for the first time, they will have to accept the EULA (End User Licence Agreement) in order to use the app.

7 PREPARATION

Unpack and prepare 1 sampler, 1 pair of nitrile gloves, 1 prefilled extraction device, 1 rapid test and 1 support frame.

7.1 EasySampler

Unpack one sampler and one pair of nitrile gloves from the plastic bag. Unfold the sampler, and inspect visually for any damage.

7.2 Test cassette

Remove the ready-to-use rapid test cassette from the aluminium pouch just prior to analysis. Inspect visually for any damage to the cassette or membrane in the test window.

8 PERFORMING THE CALPROSMART SELF-TEST

The test procedure is explained in the enclosed instructions for use (IFU) and in the CalproSmart™ application, where every step of the procedure is explained both through images and text. The app will also contain a link to an instructional video.

Log in to the CalproSmart app on your device, before preparing the test. Internet connection is required during login to the app.

- If you are using the CalproSmart standalone solution, you will log in by clicking on the CalproSmart icon on your mobile phone and log in with your credentials
- If you are using CalproSmart through a 3rd party/ host app, you will log in through the host app by clicking the button to measure your Calprotectin levels. Please refer to host app IFU for more details

! Important:: Let the app guide you! For each instruction in the app, press next, perform the steps as shown in the app to make sure that all steps are performed in timely manner.

! Important: Remember to use the timers (3 minutes shaking time for the extraction device and 15 minutes incubation time for the test cassette) inside the app. The timers start automatically when pressing next at the step before the timer function.

8.1 Collection of faecal sample

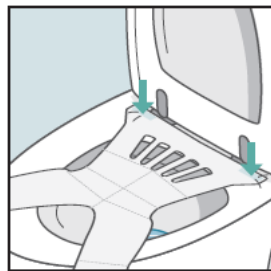
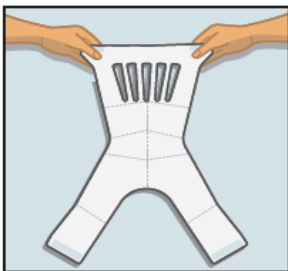

1. Put up the toilet seat before EasySampler is mounted and dry off the toilet bowl so the EasySampler can be mounted on a clean and dry surface.
2. Unfold the EasySampler. Remove the two tape protections from the EasySampler and mount them on the back of the bowl.
3. Remove the remaining tape protection and mount the front part of the EasySampler at each side in mid position of the bowl, leaving space to dispose toilet paper in front of EasySampler. It is important that the EasySampler is mounted so it creates a sample area.

! **Important:** EasySampler must NOT touch the surface of the water.

4. Finally put down the toilet seat. EasySampler is now ready for use. Have a bowel moment

! **Important:** The sample must NOT come in contact with toilet water or urine.

8.2 Extraction using the extraction device

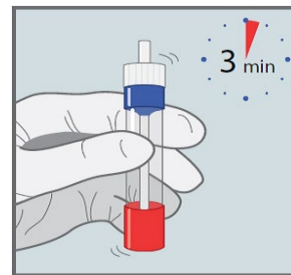
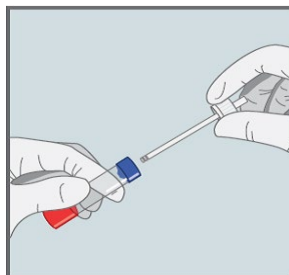

1. Put on the nitrile gloves. Turn the white cap counterclockwise and pull the cap and stick straight up. Place the tube with the blue adapter steady, e.g. in a cup or in a rack. Insert the end of the rod into the stool sample so that both grooves in the stick are completely filled. If possible, insert the rod repeatedly in different places in the stool. Avoid filling the grooves with air bubbles. Also avoid grains, fiber, etc.
2. Hold the tube with the blue cap (adapter) and press the stick with the stool through the hole in the blue adaptor. Excess stool is wiped off in the funnel insert. Turn the white cap clockwise onto the blue adapter until you feel a click and it stops. Ensure that the tube is completely closed, and shake it vigorously for 3 minutes

8.3 Applying the sample on the test cassette

Preparation: Please read the test protocol carefully *before* performing the assay

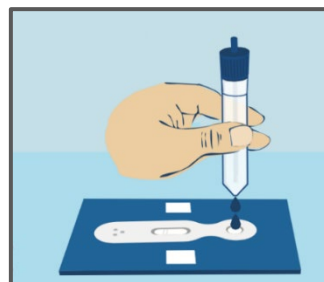
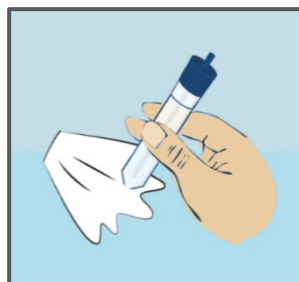

1. Place the rapid test in the support frame.
2. Remove the red cap and throw away the first drop. Wipe the tip of the device with paper to ensure the tip is dry.
3. Hold the device vertically above the test cassette and apply 2 drops (equivalent to 80 µl) onto the rapid test. Incubate in room temperature for 15 minutes.

Important: Normally you will see the applied liquid move in the cartridge window. If this is not observed within 30 seconds, add one additional drop of extract to obtain normal flow.

8.4 Performing the measurements

1. Hold the Smartphone horizontally over the support frame with the embedded rapid test.

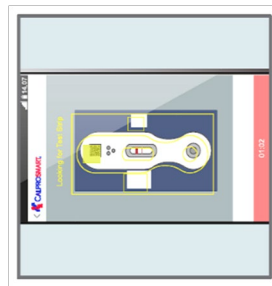
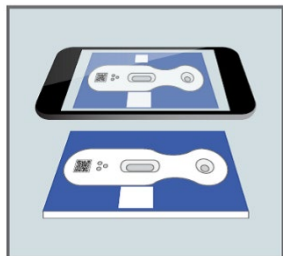

2. The picture is taken automatically when the barcode, Test line and Control line is identified by Smartphone application.
3. The results will be stored automatically Once the test has been measured. Depending on the study type (non-blinded/blinded), you may see a numerical value for the results or receive a confirmation of submitted results only. If you are shown the results, you will see a numerical value along with a color-coded bar to show where the value fits within the range of the test.

8.5 Disposal

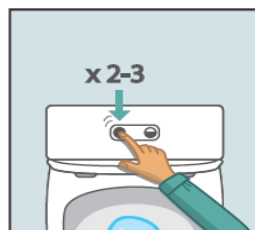

1. After completing the test, remove the gloves. Put the used extraction device, rapid test cassette and gloves into the empty plastic bag of the sampler and dispose. Wash your hands to prevent contamination from sample.

! **Important:** Do **NOT** discard the support frame! This should be used for all tests in CalproSmart kit. In the event of discarding or losing the frame, an additional support frame is included in the kit as a spare.

2. Remove EasySampler from the Bowl and flush it out in the toilet.

! **Important:** When using water-saving toilets use full flush. Repeat it until the amount of water are 10-15 litre. Tape leftovers on the bowl can easily be removed with denatured spirit.

9 QUALITY CONTROL

4. The Control and Test lines should be clear and well defined. If the Control line are missing, or the quality of the C and/or T-line is not acceptable, an error message will appear, and a new test should be performed.
5. If the Calprotectin level is below the detection limit, a test line will not be seen, and the results will be reported as <77 mg/kg (green zone).
6. If the bar code is damaged, it will not be detected by the software and a message stating "looking for barcode" will appear at the top of the screen. If barcode is not found within 2 minutes, the test will terminate without results
7. If the test cassette has expired, the error message will appear when scanning the test cassette without any results being registered.

10 LIMITATIONS OF THE PROCEDURE

Procedure: It is important to follow the instructions carefully to get an accurate result.

Both grooves in the rod of the extraction device should be completely filled. If possible, insert the rod repeatedly in different places in the stool. Avoid filling the grooves with air bubbles. Also avoid grains, fiber, etc. For very liquid stools, insert the rod deep into the sample to ensure the grooves are completely filled. It is not a problem if the grooves are overfilled. The extra material will be scraped off as you insert the rod back in the extraction device.

Extraction device should be held vertically over the application well, when the 2 drops of extract are put onto the rapid test. Tilting the extraction device may cause wrong volume of the drops.

 **Important:** Wrongly performed procedure, wrong amount of collected faecal sample or wrong volume of extracts put onto the rapid test cassette, could all cause false positive or negative results.

11 PRECAUTIONS AND WARNINGS

- **For research use only..**
- Read the Instructions for Use carefully before performing the test.
- Avoid splashing or skin contact with the liquid in the extraction tube. The liquid contains small amounts of Sodium Azide which can be toxic. If the liquid comes into contact with the eyes, rinse well with clean water. Should NOT be consumed. KEEP OUT OF THE REACH OF CHILDREN!
- Ensure that the extraction device is held vertically over the application well, when the 2 drops of extract are put onto the rapid test. Tilting the extraction device may cause wrong volume of the drops.
- Do NOT read the same test cassette several times. If the time limit for measuring the test is exceeded, the test must be performed from the start with a new extraction device and a new rapid test cassette.
- Ensure that both grooves in the stick of the extraction device always are completely filled. For very liquid samples, insert the rod deep into the sample to ensure the grooves are completely filled.
- Avoid carrying out the test in a dark room.
- Do not interchange reagents of different production lots.
- Do not use reagents from other manufacturers with reagents of this test kit.
- Do not use reagents after expiry date stated on the label
- The extraction buffer contains sodium azide at less than 0.1% (w/v).

12 DISPOSAL CONSIDERATIONS







Fecal extracts are potential contagious and should be treated as hazardous waste. Be sure that the extraction device is completely closed after use, to prevent leakage/spillage to the surroundings. All used component (except from the EasySampler) should be placed in the empty plastic bag of the sampler, before closed securely and disposed.

13 REFERENCES

1. Johnstone B et al.: Functional and clinical aspects of the myelomonocytic protein calprotectin. *J Clin Pathol: Mol Pathol* 1997; 50:113-123.
2. Fagerhol MK et al.: Calprotectin (The L1 leukocyte protein) in: Smith VL and Dedman JR (eds): Stimulus response coupling: The role of intracellular calcium-binding proteins. CRC Press, Boca Raton 1990, p. 187-210
3. Røseth AG et al.: Assessment of the neutrophil dominating protein calprotectin in faeces. *Scand J Gastroenterol* 1992; 27: 793-798.
4. Dale I et al.: Purification and partial characterization of a highly immunogenic human leukocyte protein, the L1 antigen. *Eur J Biochem* 1983;134: 1-6.
5. Dale I et al.: Distribution of a new myelomonocytic antigen (L1) in human peripheral blood leukocytes. *American J of Clin Pathology* 1985; 84: 24-34
6. Brandtzaeg P et al.: Distribution of a formalin-resistant myelomonocytic antigen (L1) in human tissues. II. Normal and aberrant occurrence in various epithelia. *American J of Clin Pathology* 1987; 87: 700-707.
7. Fagerhol MK: Nomenclature for proteins: is calprotectin a proper name for the elusive myelomonocytic protein? *J Clin Pathol: Mol Pathol* 1996; 49: M74-M79.
8. Isaksen B and Fagerhol MK: Calprotectin inhibits matrix metalloproteinases by sequestration of zinc. *J Clin Pathol: Mol Pathol* 2001; 54: 289-292.
9. Steinbakk M et al.: Antimicrobial actions of calcium binding leukocyte L1 protein, calprotectin. *Lancet* 1990; 336: 763-765.
10. Yui S et al.: Induction of apoptotic cell death in mouse lymphoma and human leukaemia cell lines by a calcium-binding protein complex, calprotectin, derived from inflammatory peritoneal exudates cells. *Journal of Leukocyte Biology* 1995; 58: 650-658.

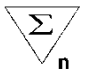
14 ORDER INFORMATION

CalproSmart™ RUO are available in one-test kit size. For a complete list of all product variants with product code, please visit our web page: www.calpro.no.

Symbols Key/ Symbolschlüssel/ Explication des symboles / Legenda / Símbolos	
	Lot Number/ Chargenbezeichnung/ Numéro de lot/ Lotto/ Número de lote
	Expiration Date/ Verfallsdatum/ Date de péremption/ Scadenza/ Fecha de caducidad
	Storage Temperature/ Lagertemperatur/ Température de conservation/ Temperatura di conservazione / Temperatura de almacenamiento
[REF]	Catalogue Number/ Katalog Nummer/ Référence du catalogue/ Numero di codice/ Número de Catálogo
	Contains sufficient for "n" tests/ Ausreichend für "n" Tests/ Contenu suffisant pour "n" tests/ Contenuto sufficiente per "n" saggi/ Contenido suficiente para "n" tests
	Do not reuse/nicht wiederverwenden/ ne pas réutiliser/ non riutilizzare/ no reutilizar
	Consult instructions for use/Gebrauchsanweisung konsultieren/consulter les instructions d'utilisation/consultare le istruzioni per l'uso/consultar instrucciones de uso
	This side up/Diese Seite oben/ce côté vers le haut/questo lato in su/Este lado hacia arriba

Calpro is a registered trademark of Calpro AS, Lysaker, Norway

version 1 (03.01.25)

Manufactured by:

Produced within the EU for CALPRO AS

CALPRO AS

Arnstein Arnebergs vei 30

N-1366 Lysaker, Norway

Tel: +47 40 00 42 79

mail@calpro.no

www.calpro.no